

Pulegge dentate per cinghie passo metrico
Timing belt pulleys metric pitch
Zahnriemenscheiben metrische teilung
Poulies dentées pour courroies pas métrique
Poleas dentadas para correas con paso metrico

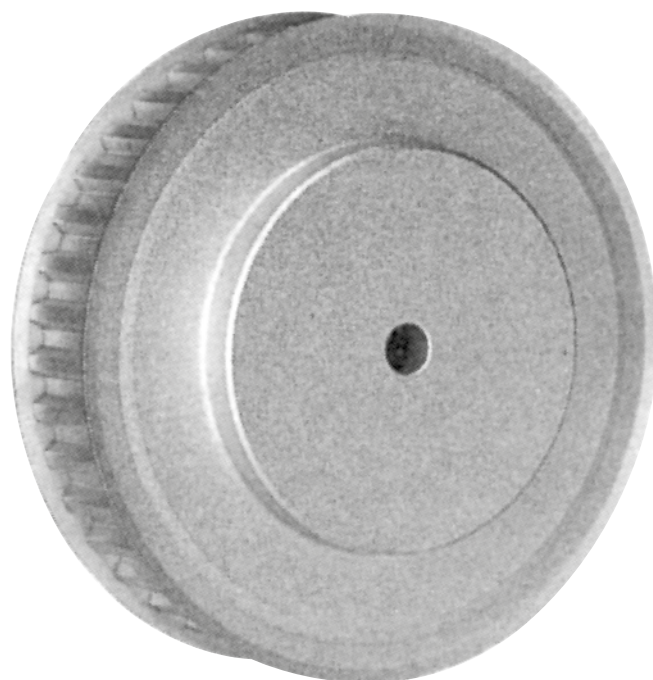

Istruzioni per l'identificazione e la classificazione delle pulegge a passo metrico

Instructions for the identification and classification of timing belt pulleys metric pitch

Leitfaden zur suche und Klassifizierung der Zahnriemenscheiben metrische Teilung

Instructions pour la recherche et la classification des poulies dentées pas métrique

Guia a la busca y clasificación de las poleas dentadas en paso metrico

Esempio:
ALTEZZA 40 T 10/32-2

40 = Larghezza totale della puleggia 40 mm (L)
T10 = Passo 10 mm
30 = N. denti
2 = N. della flangia

Example:
PULLEY 40 T 10/32-2

40 = Total width of pulley 40 mm (L)
T10 = Pitch 10 mm
30 = No. of teeth
2 = No. of flanges

Beispiel:
SCHIBE 40 T 10/32-2

40 = Gesamtbreite der Scheibe 40 mm (L)
T10 = Teilung 10 mm
30 = Zähnezahl
2 = Anzahl der Bordscheiben

Exemple:
POULIE 40 T 10/32-2

40 = Largeur totale de la poulie 40 mm (L)
T10 = Pas 10 mm
30 = N. de dents
2 = N. de flasques

Ejemplo:
POLEA 40 T 10/32-2

40 = Ancho total de la polea 40 mm (L)
T10 = Paso 10 mm
30 = Cantidad de dientes
2 = Cantidad de tapetas

Materiale:
alluminio 6082 T6
UNI 9006/4 adatto al trattamento anodico

Material:
aluminium 6082 T6 UNI 9006/4 suitable for anodic treatment

Werkstoff:
aluminium 6082 T6 UNI 9006/4 geeignet für anodischen oxydation

Matière:
aluminium 6082 T6 UNI 9006/4 apte au traitement anodique

Material:
aluminio 6082 T6 UNI 9006/4 apto para la oxidacion anodica

Pulegge dentate per cinghie passo metrico / Timing belt pulleys metric pitch

Zahnriemenscheiben metrische Teilung / Poulies dentées pour courroies pas métrique

Poleas dentadas para correas con paso metrico

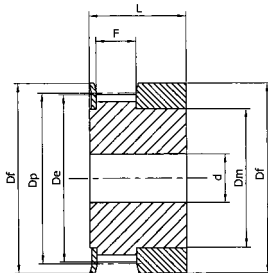

Tipo / Type
1F

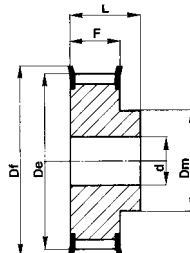

Tipo / Type
6F

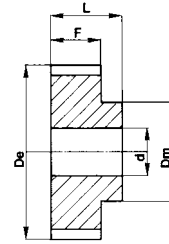

Tipo / Type
6

T 2,5

(Paso 2,5 mm)
per cinghia larghezza 6 mm

(Pitch 2,5 mm)
for belt width 6 mm

(Teilung 2,5 mm)
für Riemenbreite 6 mm

(Pas 2,5 mm)
pour courroies largeur 6 mm

(Paso 2,5 mm)
para correas ancho 6 mm

| Code symbol / Fabriknummer Code symbole / Numero de fabrica | Nostro codice Our code / Unser kode Notre code / Nuestro codigo | Tipo Type / Typ Type / Tipo | Tipo flangia Flanges type / Bordscheiben Typ Type flasques / Tipo tapetas | N. denti N. of teeth / Zähnezahl N. bre de dents / Cantidad de dientes | Dp | De | Df | Dm | F | L | d | Peso / Weight Gewicht / Poids / Peso Kg |
|--|---|-----------------------------------|---|--|-------|-------|------|------|----|----|---|---|
| 16T2,5/12-2 | 16T2012 | 1F | F01 | 12 | 9,60 | 9,00 | 13,0 | 6,0 | 9 | 16 | 4 | 0,004 |
| 16T2,5/14-2 | 16T2014 | 1F | F02 | 14 | 11,20 | 10,60 | 15,0 | 8,0 | 9 | 16 | 4 | 0,006 |
| 16T2,5/15-2 | 16T2015 | 1F | F02 | 15 | 12,00 | 11,40 | 15,0 | 8,0 | 9 | 16 | 4 | 0,006 |
| 16T2,5/16-2 | 16T2016 | 1F | F03 | 16 | 12,80 | 12,20 | 16,0 | 9,5 | 9 | 16 | 4 | 0,006 |
| 16T2,5/18-2 | 16T2018 | 6F | F04 | 18 | 14,40 | 13,80 | 17,5 | 10,0 | 10 | 16 | 4 | 0,006 |
| 16T2,5/19-2 | 16T2019 | 6F | F05 | 19 | 15,20 | 14,60 | 18,0 | 10,0 | 10 | 16 | 4 | 0,007 |
| 16T2,5/20-2 | 16T2020 | 6F | F06 | 20 | 16,00 | 15,40 | 20,0 | 10,5 | 10 | 16 | 4 | 0,008 |
| 16T2,5/22-2 | 16T2022 | 6F | F07 | 22 | 17,60 | 17,00 | 23,0 | 11,0 | 10 | 16 | 4 | 0,010 |
| 16T2,5/24-2 | 16T2024 | 6F | F07 | 24 | 19,15 | 18,55 | 23,0 | 12,0 | 10 | 16 | 4 | 0,012 |
| 16T2,5/25-2 | 16T2025 | 6F | F07 | 25 | 19,95 | 19,35 | 23,0 | 13,0 | 10 | 16 | 4 | 0,013 |
| 16T2,5/26-2 | 16T2026 | 6F | F09 | 26 | 20,75 | 20,15 | 25,0 | 14,0 | 10 | 16 | 4 | 0,015 |
| 16T2,5/28-2 | 16T2028 | 6F | F09 | 28 | 22,35 | 21,75 | 25,0 | 14,0 | 10 | 16 | 4 | 0,016 |
| 16T2,5/30-2 | 16T2030 | 6F | F09 | 30 | 23,95 | 23,35 | 28,0 | 16,0 | 10 | 16 | 6 | 0,018 |
| 16T2,5/32-2 | 16T2032 | 6F | F10 | 32 | 25,95 | 24,95 | 32,0 | 16,0 | 10 | 16 | 6 | 0,020 |
| 16T2,5/36-2 | 16T2036 | 6F | F12 | 36 | 28,75 | 28,10 | 36,0 | 20,0 | 10 | 16 | 6 | 0,026 |
| 16T2,5/40-2 | 16T2040 | 6F | F14 | 40 | 31,90 | 31,30 | 38,0 | 22,0 | 10 | 16 | 6 | 0,032 |
| 16T2,5/44-0 | 16T2044 | 6F | F15 | 44 | 35,10 | 34,50 | 42,0 | 24,0 | 10 | 16 | 6 | 0,038 |
| 16T2,5/48-0 | 16T2048 | 6 | - | 48 | 38,30 | 37,70 | - | 26,0 | 10 | 16 | 6 | 0,048 |
| 16T2,5/60-0 | 16T2060 | 6 | - | 60 | 47,85 | 47,25 | - | 34,0 | 10 | 16 | 8 | 0,073 |

Per pulegge aventi un numero di denti diverso dalla tabella, consultateci.

For pulleys with a number of teeth not included in these tables please ask for our quotation.

Verlagen sie angebot für Zahnscheiben mit Anzahl von Zähnen die nicht in diesen Tafeln aufgefuehrt sind.

Pour les poulies avec un nombre de dents different du tableau, nous consulter.

Pidan oferta por lo que concierne una cantidad de dientes no incluida en estas tablas.

Pulegge dentate per cinghie passo metrico / Timing belt pulleys metric pitch
Zahnriemenscheiben metrische Teilung / Poulies dentées pour courroies pas métrique
Poleas dentadas para correas con paso metrico



Materiale: alluminio 6082 T6 UNI 9006/4 adatto al trattamento anodico
Material: aluminium 6082 T6 UNI 9006/4 suitable for anodic treatment
Werkstoff: aluminium 6082 T6 UNI 9006/4 geeignet für anodischen oxydation
Matière: aluminium 6082 T6 UNI 9006/4 apte au traitement anodique
Material: aluminio 6082 T6 UNI 9006/4 apto para la oxidacion anodica

Tipo / Type
6F

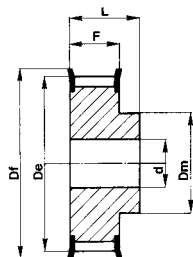

Tipo / Type
6

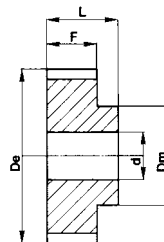

T 5

(Passo 5 mm) per cinghia larghezza 10 mm (Pitch 5 mm) for belt width 10 mm (Teilung 5 mm) für Riemenbreite 10 mm (Pas 5 mm) pour courroies largeur 10 mm (Paso 5 mm) para correas ancho 10 mm

| Code symbol / Fabriknummer / Code symbole / Numero de fabrica | Nostro codice / Our code / Unser kode / Notre code / Nuestro codigo | Tipo / Type / Typ / Type | Tipo flangia / Flanges type / Bordscheiben Typ / Type flasques / Tipo tapetas | N. denti / N. of teeth / Zahnezahl / N. bre de dents / Cantidad de dientes | Dp | De | Df | Dm | F | L | d | Peso / Weight / Gewicht / Poids / Peso / Kg |
|---|---|--------------------------|---|--|-------|-------|------|----|----|----|---|---|
| 21T5/10-2 | 21T5010 | 6F | F06 | 10 | 16,05 | 15,05 | 20,0 | 8 | 15 | 21 | 4 | 0,012 |
| 21T5/12-2 | 21T5012 | 6F | F07 | 12 | 19,25 | 18,25 | 23,0 | 11 | 15 | 21 | 4 | 0,016 |
| 21T5/14-2 | 21T5014 | 6F | F08 | 14 | 22,45 | 21,45 | 25,0 | 13 | 15 | 21 | 4 | 0,019 |
| 21T5/15-2 | 21T5015 | 6F | F09 | 15 | 24,05 | 23,05 | 28,0 | 16 | 15 | 21 | 6 | 0,021 |
| 21T5/16-2 | 21T5016 | 6F | F10 | 16 | 25,06 | 24,60 | 32,0 | 18 | 15 | 21 | 6 | 0,025 |
| 21T5/18-2 | 21T5018 | 6F | F10 | 18 | 28,80 | 27,80 | 32,0 | 20 | 15 | 21 | 6 | 0,031 |
| 21T5/19-2 | 21T5019 | 6F | F12 | 19 | 30,40 | 29,40 | 36,0 | 22 | 15 | 21 | 6 | 0,036 |
| 21T5/20-2 | 21T5020 | 6F | F12 | 20 | 32,00 | 31,00 | 36,0 | 23 | 15 | 21 | 6 | 0,038 |
| 21T5/22-2 | 21T5022 | 6F | F14 | 22 | 35,15 | 34,15 | 38,0 | 24 | 15 | 21 | 6 | 0,054 |
| 21T5/24-2 | 21T5024 | 6F | F15 | 24 | 38,40 | 37,40 | 42,0 | 26 | 15 | 21 | 6 | 0,056 |
| 21T5/25-2 | 21T5025 | 6F | F17 | 25 | 39,95 | 38,95 | 44,0 | 26 | 15 | 21 | 6 | 0,058 |
| 21T5/26-2 | 21T5026 | 6F | F17 | 26 | 41,60 | 40,60 | 44,0 | 26 | 15 | 21 | 6 | 0,064 |
| 21T5/27-2 | 21T5027 | 6F | F18 | 27 | 43,20 | 42,20 | 48,0 | 30 | 15 | 21 | 8 | 0,070 |
| 21T5/28-2 | 21T5028 | 6F | F18 | 28 | 44,75 | 43,75 | 48,0 | 32 | 15 | 21 | 8 | 0,075 |
| 21T5/30-2 | 21T5030 | 6F | F19 | 30 | 47,95 | 46,95 | 51,0 | 34 | 15 | 21 | 8 | 0,081 |
| 21T5/32-2 | 21T5032 | 6F | F20 | 32 | 51,10 | 50,10 | 54,0 | 38 | 15 | 21 | 8 | 0,088 |
| 21T5/36-2 | 21T5036 | 6F | F24 | 36 | 57,45 | 56,45 | 64,0 | 38 | 15 | 21 | 8 | 0,114 |
| 21T5/40-2 | 21T5040 | 6F | F25 | 40 | 63,85 | 62,85 | 66,0 | 40 | 15 | 21 | 8 | 0,138 |
| 21T5/42-2 | 21T5042 | 6F | F26 | 42 | 67,00 | 66,00 | 70,0 | 40 | 15 | 21 | 8 | 0,165 |
| 21T5/44-0 | 21T5044 | 6 | - | 44 | 70,20 | 69,20 | - | 45 | 15 | 21 | 8 | 0,200 |
| 21T5/48-0 | 21T5048 | 6 | - | 48 | 76,55 | 75,55 | - | 50 | 15 | 21 | 8 | 0,307 |
| 21T5/60-0 | 21T5060 | 6 | - | 60 | 95,65 | 94,65 | - | 65 | 15 | 21 | 8 | 0,180 |

(Passo 5 mm) per cinghia larghezza 16 mm (Pitch 5 mm) for belt width 16 mm (Teilung 5 mm) für Riemenbreite 16 mm (Pas 5 mm) pour courroies largeur 16 mm (Paso 5 mm) para correas ancho 16 mm

| Code symbol / Fabriknummer / Code symbole / Numero de fabrica | Nostro codice / Our code / Unser kode / Notre code / Nuestro codigo | Tipo / Type / Typ / Type | Tipo flangia / Flanges type / Bordscheiben Typ / Type flasques / Tipo tapetas | N. denti / N. of teeth / Zahnezahl / N. bre de dents / Cantidad de dientes | Dp | De | Df | Dm | F | L | d | Peso / Weight / Gewicht / Poids / Peso / Kg |
|---|---|--------------------------|---|--|-------|-------|------|----|----|----|---|---|
| 27T5/10-2 | 27T5010 | 6F | F06 | 10 | 16,05 | 15,05 | 20,0 | 8 | 21 | 27 | 4 | 0,016 |
| 27T5/12-2 | 27T5012 | 6F | F07 | 12 | 19,25 | 18,25 | 23,0 | 11 | 21 | 27 | 4 | 0,022 |
| 27T5/14-2 | 27T5014 | 6F | F08 | 14 | 22,45 | 21,45 | 25,0 | 13 | 21 | 27 | 4 | 0,026 |
| 27T5/15-2 | 27T5015 | 6F | F09 | 15 | 24,05 | 23,05 | 28,0 | 16 | 21 | 27 | 6 | 0,029 |
| 27T5/16-2 | 27T5016 | 6F | F10 | 16 | 25,06 | 24,60 | 32,0 | 18 | 21 | 27 | 6 | 0,035 |
| 27T5/18-2 | 27T5018 | 6F | F10 | 18 | 28,80 | 27,80 | 32,0 | 20 | 21 | 27 | 6 | 0,043 |
| 27T5/19-2 | 27T5019 | 6F | F12 | 19 | 30,40 | 29,40 | 36,0 | 22 | 21 | 27 | 6 | 0,049 |
| 27T5/20-2 | 27T5020 | 6F | F12 | 20 | 32,00 | 31,00 | 36,0 | 23 | 21 | 27 | 6 | 0,053 |
| 27T5/22-2 | 27T5022 | 6F | F14 | 22 | 35,15 | 34,15 | 38,0 | 24 | 21 | 27 | 6 | 0,062 |
| 27T5/24-2 | 27T5024 | 6F | F15 | 24 | 38,40 | 37,40 | 42,0 | 26 | 21 | 27 | 6 | 0,076 |
| 27T5/25-2 | 27T5025 | 6F | F17 | 25 | 39,95 | 38,95 | 44,0 | 26 | 21 | 27 | 6 | 0,081 |
| 27T5/26-2 | 27T5026 | 6F | F17 | 26 | 41,60 | 40,60 | 44,0 | 26 | 21 | 27 | 6 | 0,085 |
| 27T5/27-2 | 27T5027 | 6F | F18 | 27 | 43,20 | 42,20 | 48,0 | 30 | 21 | 27 | 8 | 0,090 |
| 27T5/28-2 | 27T5028 | 6F | F18 | 28 | 44,75 | 43,75 | 48,0 | 32 | 21 | 27 | 8 | 0,095 |
| 27T5/30-2 | 27T5030 | 6F | F19 | 30 | 47,95 | 46,95 | 51,0 | 34 | 21 | 27 | 8 | 0,105 |
| 27T5/32-2 | 27T5032 | 6F | F20 | 32 | 51,10 | 50,10 | 54,0 | 38 | 21 | 27 | 8 | 0,123 |
| 27T5/36-2 | 27T5036 | 6F | F24 | 36 | 57,45 | 56,45 | 64,0 | 38 | 21 | 27 | 8 | 0,160 |
| 27T5/40-2 | 27T5040 | 6F | F25 | 40 | 63,85 | 62,85 | 66,0 | 40 | 21 | 27 | 8 | 0,193 |
| 27T5/42-2 | 27T5042 | 6F | F26 | 42 | 67,00 | 66,00 | 70,0 | 40 | 21 | 27 | 8 | 0,245 |
| 27T5/44-0 | 27T5044 | 6 | - | 44 | 70,20 | 69,20 | - | 45 | 21 | 27 | 8 | 0,280 |
| 27T5/48-0 | 27T5048 | 6 | - | 48 | 76,55 | 75,55 | - | 50 | 21 | 27 | 8 | 0,430 |
| 27T5/60-0 | 27T5060 | 6 | - | 60 | 95,65 | 94,65 | - | 65 | 21 | 27 | 8 | 0,108 |

(Passo 5 mm) per cinghia larghezza 25 mm (Pitch 5 mm) for belt width 25 mm (Teilung 5 mm) für Riemenbreite 25 mm (Pas 5 mm) pour courroies largeur 25 mm (Paso 5 mm) para correas ancho 25 mm

| Code symbol / Fabriknummer / Code symbole / Numero de fabrica | Nostro codice / Our code / Unser kode / Notre code / Nuestro codigo | Tipo / Type / Typ / Type | Tipo flangia / Flanges type / Bordscheiben Typ / Type flasques / Tipo tapetas | N. denti / N. of teeth / Zahnezahl / N. bre de dents / Cantidad de dientes | Dp | De | Df | Dm | F | L | d | Peso / Weight / Gewicht / Poids / Peso / Kg |
|---|---|--------------------------|---|--|-------|-------|------|----|----|----|---|---|
| 36T5/10-2 | 36T5010 | 6F | F06 | 10 | 16,05 | 15,05 | 20,0 | 8 | 30 | 36 | 4 | 0,023 |
| 36T5/12-2 | 36T5012 | 6F | F07 | 12 | 19,25 | 18,25 | 23,0 | 11 | 30 | 36 | 4 | 0,031 |
| 36T5/14-2 | 36T5014 | 6F | F08 | 14 | 22,45 | 21,45 | 25,0 | 13 | 30 | 36 | 4 | 0,037 |
| 36T5/15-2 | 36T5015 | 6F | F09 | 15 | 24,05 | 23,05 | 28,0 | 16 | 30 | 36 | 6 | 0,041 |
| 36T5/16-2 | 36T5016 | 6F | F10 | 16 | 25,06 | 24,60 | 32,0 | 18 | 30 | 36 | 6 | 0,050 |
| 36T5/18-2 | 36T5018 | 6F | F10 | 18 | 28,80 | 27,80 | 32,0 | 20 | 30 | 36 | 6 | 0,061 |
| 36T5/19-2 | 36T5019 | 6F | F12 | 19 | 30,40 | 29,40 | 36,0 | 22 | 30 | 36 | 6 | 0,070 |
| 36T5/20-2 | 36T5020 | 6F | F12 | 20 | 32,00 | 31,00 | 36,0 | 23 | 30 | 36 | 6 | 0,076 |
| 36T5/22-2 | 36T5022 | 6F | F14 | 22 | 35,15 | 34,15 | 38,0 | 24 | 30 | 36 | 6 | 0,092 |
| 36T5/24-2 | 36T5024 | 6F | F15 | 24 | 38,40 | 37,40 | 42,0 | 26 | 30 | 36 | 8 | 0,109 |
| 36T5/25-2 | 36T5025 | 6F | F17 | 25 | 39,95 | 38,95 | 44,0 | 26 | 30 | 36 | 8 | 0,116 |
| 36T5/26-2 | 36T5026 | 6F | F17 | 26 | 41,60 | 40,60 | 44,0 | 26 | 30 | 36 | 8 | 0,121 |
| 36T5/27-2 | 36T5027 | 6F | F18 | 27 | 43,20 | 42,20 | 48,0 | 30 | 30 | 36 | 8 | 0,128 |
| 36T5/28-2 | 36T5028 | 6F | F18 | 28 | 44,75 | 43,75 | 48,0 | 32 | 30 | 36 | 8 | 0,142 |
| 36T5/30-2 | 36T5030 | 6F | F19 | 30 | 47,95 | 46,95 | 51,0 | 34 | 30 | 36 | 8 | 0,150 |
| 36T5/32-2 | 36T5032 | 6F | F20 | 32 | 51,10 | 50,10 | 54,0 | 38 | 30 | 36 | 8 | 0,176 |
| 36T5/36-2 | 36T5036 | 6F | F24 | 36 | 57,45 | 56,45 | 64,0 | 38 | 30 | 36 | 8 | 0,230 |
| 36T5/40-2 | 36T5040 | 6F | F25 | 40 | 63,85 | 62,85 | 66,0 | 40 | 30 | 36 | 8 | 0,276 |
| 36T5/42-2 | 36T5042 | 6F | F26 | 42 | 67,00 | 66,00 | 70,0 | 40 | 30 | 36 | 8 | 0,352 |
| 36T5/44-0 | 36T5044 | 6 | - | 44 | 70,20 | 69,20 | - | 45 | 30 | 36 | 8 | 0,400 |
| 36T5/48-0 | 36T5048 | 6 | - | 48 | 76,55 | 75,55 | - | 50 | 30 | 36 | 8 | 0,614 |
| 36T5/60-0 | 36T5060 | 6 | - | 60 | 95,65 | 94,65 | - | 65 | 30 | 36 | 8 | 0,180 |

Pulegge dentate per cinghie passo metrico / Timing belt pulleys metric pitch Zahnriemenscheiben metrische Teilung / Poulies dentées pour courroies pas métrique Poleas dentadas para correas con paso metrico

| | | | | |
|---|--|---|---|--|
| Materiale: alluminio 6082 T6 UNI 9006/4 adatto al trattamento anodico | Material: aluminium 6082 T6 UNI 9006/4 suitable for anodic treatment | Werkstoff: aluminium 6082 T6 UNI 9006/4 geeignet für anodischen oxydation | Matière: aluminium 6082 T6 UNI 9006/4 apte au traitement anodique | Material: aluminio 6082 T6 UNI 9006/4 apto para la oxidacion anodica |
|---|--|---|---|--|

Tipo / Type
6F

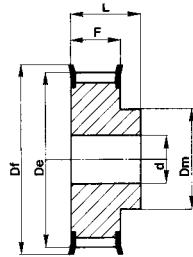

Tipo / Type
6

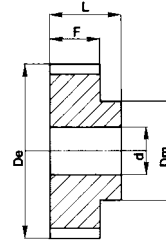

T 10

| | | | | |
|--|---------------------------------------|---|---|--|
| (Passo 10 mm) per cinghia larghezza 16 mm | (Pitch 10 mm) for belt width 16 mm | (Teilung 10 mm) für Riemenbreite 16 mm | (Pas 10 mm) pour courroies largeur 16 mm | (Paso 10 mm) para correas ancho 16 mm |
|--|---------------------------------------|---|---|--|

| Codice Code symbol / Fabriknummer Code symbole / Numero de fabrica | Nostro codice Our code / Unser kode Notre code / Nuestro codigo | Tipo Type / Typ Type / Tipo | Tipo flangia Flanges type / Bordscheiben Typ Type flasques / Tipo tapetas | N. denti N. of teeth / Zahnzahl N. bre de dents / Cantidad de dientes | Dp | De | Df | Dm | F | L | d | Peso / Weight Gewicht / Poids / Peso Kg |
|--|---|-----------------------------------|---|---|--------|--------|-----|-----|----|----|----|---|
| 31T10/12-2 | 31T1012 | 6F | F15 | 12 | 38,35 | 36,35 | 42 | 28 | 21 | 31 | 6 | 0,076 |
| 31T10/14-2 | 31T1014 | 6F | F18 | 14 | 44,70 | 42,70 | 48 | 32 | 21 | 31 | 8 | 0,104 |
| 31T10/15-2 | 31T1015 | 6F | F19 | 15 | 47,90 | 45,90 | 51 | 32 | 21 | 31 | 8 | 0,116 |
| 31T10/16-2 | 31T1016 | 6F | F20 | 16 | 51,10 | 49,10 | 54 | 35 | 21 | 31 | 8 | 0,134 |
| 31T10/18-2 | 31T1018 | 6F | F22 | 18 | 57,45 | 55,45 | 60 | 40 | 21 | 31 | 8 | 0,167 |
| 31T10/19-2 | 31T1019 | 6F | F25 | 19 | 60,65 | 58,65 | 66 | 44 | 21 | 31 | 8 | 0,184 |
| 31T10/20-2 | 31T1020 | 6F | F25 | 20 | 63,80 | 61,80 | 66 | 46 | 21 | 31 | 8 | 0,208 |
| 31T10/22-2 | 31T1022 | 6F | F27 | 22 | 70,20 | 68,20 | 75 | 52 | 21 | 31 | 8 | 0,240 |
| 31T10/24-2 | 31T1024 | 6F | F29 | 24 | 76,55 | 74,55 | 83 | 58 | 21 | 31 | 8 | 0,288 |
| 31T10/25-2 | 31T1025 | 6F | F29 | 25 | 79,75 | 77,70 | 83 | 60 | 21 | 31 | 8 | 0,295 |
| 31T10/26-2 | 31T1026 | 6F | F30 | 26 | 82,90 | 80,90 | 87 | 60 | 21 | 31 | 8 | 0,310 |
| 31T10/27-2 | 31T1027 | 6F | F31 | 27 | 86,10 | 84,10 | 91 | 60 | 21 | 31 | 8 | 0,364 |
| 31T10/28-2 | 31T1028 | 6F | F32 | 28 | 89,25 | 87,25 | 93 | 60 | 21 | 31 | 8 | 0,441 |
| 31T10/30-2 | 31T1030 | 6F | F33 | 30 | 95,65 | 93,65 | 97 | 60 | 21 | 31 | 8 | 0,493 |
| 31T10/32-2 | 31T1032 | 6F | F35 | 32 | 102,00 | 100,00 | 106 | 65 | 21 | 31 | 10 | 0,623 |
| 31T10/36-2 | 31T1036 | 6F | F38 | 36 | 114,75 | 112,75 | 120 | 70 | 21 | 31 | 10 | 0,767 |
| 31T10/40-2 | 31T1040 | 6F | F41 | 40 | 127,45 | 125,45 | 131 | 80 | 21 | 31 | 10 | 0,950 |
| 31T10/44-0 | 31T1044 | 6 | - | 44 | 140,20 | 138,20 | - | 88 | 21 | 31 | 10 | 1,090 |
| 31T10/48-0 | 31T1048 | 6 | - | 48 | 152,95 | 150,95 | - | 95 | 21 | 31 | 16 | 1,704 |
| 31T10/60-0 | 31T1060 | 6 | - | 60 | 191,15 | 189,10 | - | 110 | 21 | 31 | 16 | 1,704 |

| | | | | |
|--|---------------------------------------|---|---|--|
| (Passo 10 mm) per cinghia larghezza 25 mm | (Pitch 10 mm) for belt width 25 mm | (Teilung 10 mm) für Riemenbreite 25 mm | (Pas 10 mm) pour courroies largeur 25 mm | (Paso 10 mm) para correas ancho 25 mm |
|--|---------------------------------------|---|---|--|

| | | | | | | | | | | | | |
|------------|---------|----|-----|----|--------|--------|-----|-----|----|----|----|-------|
| 40T10/12-2 | 40T1012 | 6F | F15 | 12 | 38,35 | 36,35 | 42 | 28 | 30 | 40 | 6 | 0,099 |
| 40T10/14-2 | 40T1014 | 6F | F18 | 14 | 44,70 | 42,70 | 48 | 32 | 30 | 40 | 8 | 0,134 |
| 40T10/15-2 | 40T1015 | 6F | F19 | 15 | 47,90 | 45,90 | 51 | 32 | 30 | 40 | 8 | 0,152 |
| 40T10/16-2 | 40T1016 | 6F | F20 | 16 | 51,10 | 49,10 | 54 | 35 | 30 | 40 | 8 | 0,176 |
| 40T10/18-2 | 40T1018 | 6F | F22 | 18 | 57,45 | 55,45 | 60 | 40 | 30 | 40 | 8 | 0,224 |
| 40T10/19-2 | 40T1019 | 6F | F25 | 19 | 60,65 | 58,65 | 66 | 44 | 30 | 40 | 8 | 0,247 |
| 40T10/20-2 | 40T1020 | 6F | F25 | 20 | 63,80 | 61,80 | 66 | 46 | 30 | 40 | 8 | 0,276 |
| 40T10/22-2 | 40T1022 | 6F | F27 | 22 | 70,20 | 68,20 | 75 | 52 | 30 | 40 | 8 | 0,310 |
| 40T10/24-2 | 40T1024 | 6F | F29 | 24 | 76,55 | 74,55 | 83 | 58 | 30 | 40 | 8 | 0,392 |
| 40T10/25-2 | 40T1025 | 6F | F29 | 25 | 79,75 | 77,70 | 83 | 60 | 30 | 40 | 8 | 0,422 |
| 40T10/26-2 | 40T1026 | 6F | F30 | 26 | 82,90 | 80,90 | 87 | 60 | 30 | 40 | 8 | 0,480 |
| 40T10/27-2 | 40T1027 | 6F | F31 | 27 | 86,10 | 84,10 | 91 | 60 | 30 | 40 | 8 | 0,536 |
| 40T10/28-2 | 40T1028 | 6F | F32 | 28 | 89,25 | 87,25 | 93 | 60 | 30 | 40 | 8 | 0,590 |
| 40T10/30-2 | 40T1030 | 6F | F33 | 30 | 95,65 | 93,65 | 97 | 60 | 30 | 40 | 8 | 0,640 |
| 40T10/32-2 | 40T1032 | 6F | F35 | 32 | 102,00 | 100,00 | 106 | 65 | 30 | 40 | 10 | 0,693 |
| 40T10/36-2 | 40T1036 | 6F | F38 | 36 | 114,75 | 112,75 | 120 | 70 | 30 | 40 | 10 | 0,873 |
| 40T10/40-2 | 40T1040 | 6F | F41 | 40 | 127,45 | 125,45 | 131 | 80 | 30 | 40 | 10 | 1,067 |
| 40T10/44-0 | 40T1044 | 6 | - | 44 | 140,20 | 138,20 | - | 88 | 30 | 40 | 10 | 1,310 |
| 40T10/48-0 | 40T1048 | 6 | - | 48 | 152,95 | 150,95 | - | 95 | 30 | 40 | 16 | 1,516 |
| 40T10/60-0 | 40T1060 | 6 | - | 60 | 191,15 | 189,10 | - | 110 | 30 | 40 | 16 | 2,339 |

Pulegge dentate per cinghie passo metrico / Timing belt pulleys metric pitch
Zahnriemenscheiben metrische Teilung / Poulies dentées pour courroies pas métrique
Poleas dentadas para correas con paso metrico



Materiale:
alluminio 6082 T6 UNI
9006/4 adatto al trattamento
anodico

Material:
aluminium 6082 T6 UNI
9006/4 suitable for anodic
treatment

Werkstoff:
aluminium 6082 T6 UNI
9006/4 geeignet für
anodischen oxydation

Matière:
aluminium 6082 T6 UNI
9006/4 apte au traitement
anodique

Material:
aluminio 6082 T6 UNI
9006/4 apto para la
oxidacion anodica

Tipo / Type
6F

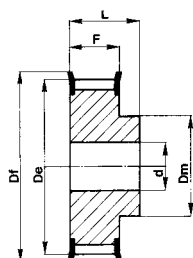

Tipo / Type
6

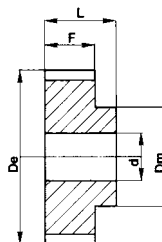

T 10

(Paso 10 mm)
 per cinghia larghezza 32 mm

(Pitch 10 mm)
 for belt width 32 mm

(Teilung 10 mm)
 für Riemenbreite 32 mm

(Pas 10 mm)
 pour courroies largeur 32 mm

(Paso 10 mm)
 para correas ancho 32 mm

| Codice Code symbol / Fabriknummer Code symbole / Numero de fabrica | Nostro codice Our code / Unser kode Notre code / Nuestro codigo | Tipo Type / Typ Type / Tipo | Tipo flangia Flanges type / Bordscheiben Typ Type flasques / Tipo tapetas | N. denti N. of teeth / Zahnezahl N. bre de dents / Cantidad de dientes | Dp | De | Df | Dm | F | L | d | Peso / Weight Gewicht / Poids / Peso Kg |
|--|---|-----------------------------------|---|--|--------|--------|-----|-----|----|----|----|---|
| 47T10/18-2 | 47T1018 | 6F | F22 | 18 | 57,45 | 55,45 | 60 | 40 | 37 | 47 | 10 | 0,253 |
| 47T10/19-2 | 47T1019 | 6F | F25 | 19 | 60,65 | 58,65 | 66 | 44 | 37 | 47 | 10 | 0,286 |
| 47T10/20-2 | 47T1020 | 6F | F25 | 20 | 63,80 | 61,80 | 66 | 46 | 37 | 47 | 12 | 0,322 |
| 47T10/22-2 | 47T1022 | 6F | F27 | 22 | 70,20 | 68,20 | 75 | 52 | 37 | 47 | 12 | 0,393 |
| 47T10/24-2 | 47T1024 | 6F | F29 | 24 | 76,55 | 74,55 | 83 | 58 | 37 | 47 | 12 | 0,475 |
| 47T10/25-2 | 47T1025 | 6F | F29 | 25 | 79,75 | 77,70 | 83 | 60 | 37 | 47 | 12 | 0,527 |
| 47T10/26-2 | 47T1026 | 6F | F30 | 26 | 82,90 | 80,90 | 87 | 60 | 37 | 47 | 12 | 0,564 |
| 47T10/27-2 | 47T1027 | 6F | F31 | 27 | 86,10 | 84,10 | 91 | 60 | 37 | 47 | 12 | 0,602 |
| 47T10/28-2 | 47T1028 | 6F | F32 | 28 | 89,25 | 87,25 | 93 | 60 | 37 | 47 | 12 | 0,642 |
| 47T10/30-2 | 47T1030 | 6F | F33 | 30 | 95,65 | 93,65 | 97 | 60 | 37 | 47 | 12 | 0,740 |
| 47T10/32-2 | 47T1032 | 6F | F35 | 32 | 102,00 | 100,00 | 106 | 65 | 37 | 47 | 12 | 0,844 |
| 47T10/36-2 | 47T1036 | 6F | F38 | 36 | 114,75 | 112,75 | 120 | 70 | 37 | 47 | 16 | 1,063 |
| 47T10/40-2 | 47T1040 | 6F | F41 | 40 | 127,45 | 125,45 | 131 | 80 | 37 | 47 | 16 | 1,371 |
| 47T10/44-0 | 47T1044 | 6 | - | 44 | 140,20 | 138,20 | - | 88 | 37 | 47 | 16 | 1,611 |
| 47T10/48-0 | 47T1048 | 6 | - | 48 | 152,95 | 150,95 | - | 95 | 37 | 47 | 16 | 1,913 |
| 47T10/60-0 | 47T1060 | 6 | - | 60 | 191,10 | 189,10 | - | 110 | 37 | 47 | 16 | 3,004 |

(Paso 10 mm)
 per cinghia larghezza 50 mm

(Pitch 10 mm)
 for belt width 50 mm

(Teilung 10 mm)
 für Riemenbreite 50 mm

(Pas 10 mm)
 pour courroies largeur 50 mm

(Paso 10 mm)
 para correas ancho 50 mm

| | | | | | | | | | | | | |
|------------|---------|----|-----|----|--------|--------|-----|-----|----|----|----|-------|
| 66T10/18-2 | 66T1018 | 6F | F22 | 18 | 57,45 | 55,45 | 60 | 40 | 56 | 66 | 10 | 0,422 |
| 66T10/19-2 | 66T1019 | 6F | F25 | 19 | 60,65 | 58,65 | 66 | 44 | 56 | 66 | 10 | 0,466 |
| 66T10/20-2 | 66T1020 | 6F | F25 | 20 | 63,80 | 61,80 | 66 | 46 | 56 | 66 | 12 | 0,520 |
| 66T10/22-2 | 66T1022 | 6F | F27 | 22 | 70,20 | 68,20 | 75 | 52 | 56 | 66 | 12 | 0,640 |
| 66T10/24-2 | 66T1024 | 6F | F29 | 24 | 76,55 | 74,55 | 83 | 58 | 56 | 66 | 12 | 0,736 |
| 66T10/25-2 | 66T1025 | 6F | F29 | 25 | 79,75 | 77,70 | 83 | 60 | 56 | 66 | 12 | 0,766 |
| 66T10/26-2 | 66T1026 | 6F | F30 | 26 | 82,90 | 80,90 | 87 | 60 | 56 | 66 | 12 | 0,845 |
| 66T10/27-2 | 66T1027 | 6F | F31 | 27 | 86,10 | 84,10 | 91 | 60 | 56 | 66 | 12 | 0,946 |
| 66T10/28-2 | 66T1028 | 6F | F32 | 28 | 89,25 | 87,25 | 93 | 60 | 56 | 66 | 12 | 0,110 |
| 66T10/30-2 | 66T1030 | 6F | F33 | 30 | 95,65 | 93,65 | 97 | 60 | 56 | 66 | 12 | 1,169 |
| 66T10/32-2 | 66T1032 | 6F | F35 | 32 | 102,00 | 100,00 | 106 | 65 | 56 | 66 | 12 | 1,300 |
| 66T10/36-2 | 66T1036 | 6F | F38 | 36 | 114,75 | 112,75 | 120 | 70 | 56 | 66 | 16 | 1,637 |
| 66T10/40-2 | 66T1040 | 6F | F41 | 40 | 127,45 | 125,45 | 131 | 80 | 56 | 66 | 16 | 1,999 |
| 66T10/44-0 | 66T1044 | 6 | - | 44 | 140,20 | 138,20 | - | 88 | 56 | 66 | 16 | 2,420 |
| 66T10/48-0 | 66T1048 | 6 | - | 48 | 152,95 | 150,95 | - | 95 | 56 | 66 | 16 | 2,830 |
| 66T10/60-0 | 66T1060 | 6 | - | 60 | 191,10 | 189,10 | - | 110 | 56 | 66 | 16 | 4,366 |

Pulegge dentate per cinghie passo metrico / Timing belt pulleys metric pitch Zahnriemenscheiben metrische Teilung / Poulies dentées pour courroies pas métrique Poleas dentadas para correas con paso metrico

Materiale:
Ghisa

Material:
Cast iron

Werkstoff:
Grauguss

Matière:
Fonte

Material:
Hierro fundido

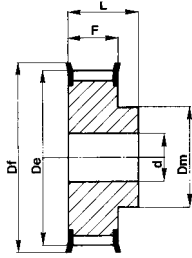

Tipo / Type
6F

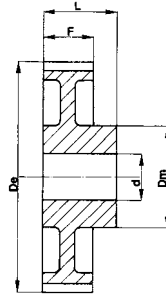

Tipo / Type
6W

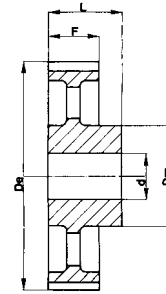

Tipo / Type
6A

T 20

(Passo 20 mm)
per cinghia larghezza 32 mm

(Pitch 20 mm)
for belt width 32 mm

(Teilung 20 mm)
für Riemenbreite 32 mm

(Pas 20 mm)
pour courroies largeur 32 mm

(Paso 20 mm)
para correas ancho 32 mm

| Codice Code symbol / Fabriknummer Code symbole / Numero de fabrica | Nostro codice Our code / Unser kode Notre code / Nuestro codigo | Tipo Type / Typ Type / Tipo | Tipo flangia Flanges type / Bordscheiben Typ Type flasques / Tipo tapetas | N. denti N. of teeth / Zahnezahl N. bre de dents / Cantidad de dientes | De | Df | Dm | F | L | d | Peso / Weight Gewicht / Poids / Peso Kg |
|--|---|-----------------------------------|---|--|--------|-----|-----|----|----|----|---|
| 53T20/18-2 | 53T2018 | 6F | F38 | 18 | 111,75 | 120 | 80 | 38 | 53 | 15 | |
| 53T20/20-2 | 53T2020 | 6F | F43 | 20 | 124,50 | 138 | 90 | 38 | 53 | 15 | |
| 53T20/22-2 | 53T2022 | 6F | F46 | 22 | 137,20 | 146 | 90 | 38 | 53 | 15 | |
| 53T20/24-2 | 53T2024 | 6F | F50 | 24 | 149,95 | 158 | 95 | 38 | 53 | 15 | |
| 53T20/25-2 | 53T2025 | 6F | F52 | 25 | 156,30 | 168 | 95 | 38 | 53 | 15 | |
| 53T20/30-2 | 53T2030 | 6F | F59 | 30 | 188,15 | 200 | 110 | 38 | 53 | 15 | |
| 53T20/32-2 | 53T2032 | 6W | | 32 | 200,85 | - | 110 | 38 | 53 | 18 | |
| 53T20/36-2 | 53T2036 | 6W | | 36 | 226,35 | - | 110 | 38 | 53 | 18 | |
| 53T20/40-2 | 53T2040 | 6A | | 40 | 251,80 | - | 110 | 38 | 53 | 20 | |
| 53T20/48-2 | 53T2048 | 6A | | 48 | 302,70 | - | 130 | 38 | 53 | 20 | |
| 53T20/60-2 | 53T2060 | 6A | | 60 | 379,10 | - | 130 | 38 | 53 | 20 | |
| 53T20/72-2 | 53T2072 | 6A | | 72 | 455,50 | - | 140 | 38 | 53 | 20 | |

(Passo 20 mm)
per cinghia larghezza 50 mm

(Pitch 20 mm)
for belt width 50 mm

(Teilung 20 mm)
für Riemenbreite 50 mm

(Pas 20 mm)
pour courroies largeur 50 mm

(Paso 20 mm)
para correas ancho 50 mm

| | | | | | | | | | | | |
|------------|---------|----|-----|----|--------|-----|-----|----|----|----|--|
| 71T20/18-2 | 71T2018 | 6F | F38 | 18 | 111,75 | 120 | 80 | 56 | 71 | 18 | |
| 71T20/20-2 | 71T2020 | 6F | F43 | 20 | 124,50 | 138 | 90 | 56 | 71 | 18 | |
| 71T20/22-2 | 71T2022 | 6F | F46 | 22 | 137,20 | 146 | 90 | 56 | 71 | 18 | |
| 71T20/24-2 | 71T2024 | 6F | F50 | 24 | 149,95 | 158 | 95 | 56 | 71 | 18 | |
| 71T20/25-2 | 71T2025 | 6F | F52 | 25 | 156,30 | 168 | 95 | 56 | 71 | 18 | |
| 71T20/30-2 | 71T2030 | 6F | F59 | 30 | 188,15 | 200 | 110 | 56 | 71 | 18 | |
| 71T20/32-2 | 71T2032 | 6W | | 32 | 200,85 | - | 110 | 56 | 71 | 20 | |
| 71T20/36-2 | 71T2036 | 6W | | 36 | 226,35 | - | 110 | 56 | 71 | 20 | |
| 71T20/40-2 | 71T2040 | 6A | | 40 | 251,80 | - | 110 | 56 | 71 | 20 | |
| 71T20/48-2 | 71T2048 | 6A | | 48 | 302,70 | - | 130 | 56 | 71 | 24 | |
| 71T20/60-2 | 71T2060 | 6A | | 60 | 379,10 | - | 130 | 56 | 71 | 24 | |
| 71T20/72-2 | 71T2072 | 6A | | 72 | 455,50 | - | 140 | 56 | 71 | 24 | |

(Passo 20 mm)
per cinghia larghezza 100 mm

(Pitch 20 mm)
for belt width 100 mm

(Teilung 20 mm)
für Riemenbreite 100 mm

(Pas 20 mm)
pour courroies largeur 100 mm

(Paso 20 mm)
para correas ancho 100 mm

| | | | | | | | | | | | |
|-------------|----------|----|-----|----|--------|-----|-----|-----|-----|----|--|
| 123T20/18-2 | 123T2018 | 6F | F38 | 18 | 111,75 | 120 | 80 | 108 | 123 | 24 | |
| 123T20/20-2 | 123T2020 | 6F | F43 | 20 | 124,50 | 138 | 90 | 108 | 123 | 24 | |
| 123T20/22-2 | 123T2022 | 6F | F46 | 22 | 137,20 | 146 | 90 | 108 | 123 | 24 | |
| 123T20/24-2 | 123T2024 | 6F | F50 | 24 | 149,95 | 158 | 95 | 108 | 123 | 24 | |
| 123T20/25-2 | 123T2025 | 6F | F52 | 25 | 156,30 | 168 | 95 | 108 | 123 | 24 | |
| 123T20/30-2 | 123T2030 | 6F | F59 | 30 | 188,15 | 200 | 110 | 108 | 123 | 24 | |
| 123T20/32-2 | 123T2032 | 6W | | 32 | 200,85 | - | 110 | 108 | 123 | 32 | |
| 123T20/36-2 | 123T2036 | 6W | | 36 | 226,35 | - | 110 | 108 | 123 | 32 | |
| 123T20/40-2 | 123T2040 | 6A | | 40 | 251,80 | - | 110 | 108 | 123 | 32 | |
| 123T20/48-2 | 123T2048 | 6A | | 48 | 302,70 | - | 130 | 108 | 123 | 32 | |
| 123T20/60-2 | 123T2060 | 6A | | 60 | 379,10 | - | 130 | 108 | 123 | 32 | |
| 123T20/72-2 | 123T2072 | 6A | | 72 | 455,50 | - | 140 | 108 | 123 | 32 | |

Barre dentate standard / Standard toothed bars

Standard Zahnriemensstagen / Barreaux dentés standard

Barras dentadas de serie



Materiale:
alluminio 6082 T6 UNI
9006/4 adatto al trattamento
anodico

Material:
aluminium 6082 T6 UNI
9006/4 suitable for anodic
treatment

Werkstoff:
aluminium 6082 T6 UNI
9006/4 geeignet für
anodischen oxydation

Matière:
aluminium 6082 T6 UNI
9006/4 apte au traitement
anodique

Material:
aluminio 6082 T6 UNI
9006/4 apto para la
oxidacion anodica

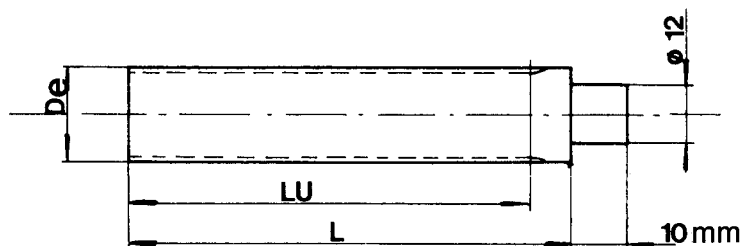

T 2,5

(Passo 2,5 mm) / (Pitch 2,5 mm) / (Teilung 2,5 mm)
(Pas 2,5 mm) / (Paso 2,5 mm)

T 5

(Passo 5 mm) / (Pitch 5 mm) / (Teilung 5 mm)
(Pas 5 mm) / (Paso 5 mm)

T 10

(Passo 10 mm) / (Pitch 10 mm) / (Teilung 10 mm)
(Pas 10 mm) / (Paso 10 mm)

| Codice Code symbol Fabriknummer Code symbole Numero de fabrica | Nostro codice Our code Unser kode Notre code Nuestro codigo | N. denti N. of teeth Zahnezahl N. bre de dents Cantidad de dientes | De | Lu | L |
|---|---|---|-------|-----|-----|
| T2,5-10 | BT25010 | 10 | 7,42 | 50 | 75 |
| T2,5-12 | BT25012 | 12 | 9,00 | 50 | 75 |
| T2,5-13 | BT25013 | 13 | 9,80 | 50 | 75 |
| T2,5-14 | BT25014 | 14 | 10,60 | 50 | 75 |
| T2,5-15 | BT25015 | 15 | 11,40 | 50 | 75 |
| T2,5-16 | BT25016 | 16 | 12,20 | 50 | 75 |
| T2,5-17 | BT25017 | 17 | 13,00 | 50 | 75 |
| T2,5-18 | BT25018 | 18 | 13,80 | 50 | 75 |
| T2,5-19 | BT25019 | 19 | 14,60 | 90 | 120 |
| T2,5-20 | BT25020 | 20 | 15,40 | 90 | 120 |
| T2,5-21 | BT25021 | 21 | 16,20 | 90 | 120 |
| T2,5-22 | BT25022 | 22 | 17,00 | 125 | 140 |
| T2,5-24 | BT25024 | 24 | 18,55 | 125 | 140 |
| T2,5-26 | BT25026 | 26 | 20,15 | 125 | 140 |
| T2,5-27 | BT25027 | 27 | 20,95 | 125 | 140 |
| T2,5-28 | BT25028 | 28 | 21,75 | 125 | 140 |
| T2,5-29 | BT25029 | 29 | 22,55 | 125 | 140 |
| T2,5-30 | BT25030 | 30 | 23,35 | 125 | 140 |
| T2,5-32 | BT25032 | 32 | 24,95 | 125 | 140 |
| T2,5-34 | BT25034 | 34 | 26,55 | 125 | 140 |
| T2,5-35 | BT25035 | 35 | 27,35 | 132 | 140 |
| T2,5-36 | BT25036 | 36 | 28,10 | 132 | 140 |
| T2,5-38 | BT25038 | 38 | 29,70 | 132 | 140 |
| T2,5-40 | BT25040 | 40 | 31,30 | 132 | 140 |
| T2,5-42 | BT25042 | 42 | 32,90 | 140 | 140 |
| T2,5-44 | BT25044 | 44 | 34,50 | 140 | 140 |
| T2,5-45 | BT25045 | 45 | 35,30 | 140 | 140 |
| T2,5-48 | BT25048 | 48 | 37,70 | 140 | 140 |
| T2,5-50 | BT25050 | 50 | 39,29 | 160 | 160 |
| T2,5-60 | BT25060 | 60 | 47,25 | 160 | 160 |
| T2,5-65 | BT25065 | 65 | 51,20 | 160 | 160 |
| T2,5-70 | BT25070 | 70 | 55,20 | 160 | 160 |
| T2,5-72 | BT25072 | 72 | 56,80 | 160 | 160 |
| T2,5-90 | BT25090 | 90 | 71,12 | 160 | 160 |
| T2,5-100 | BT25100 | 100 | 79,08 | 160 | 160 |

| Codice Code symbol Fabriknummer Code symbole Numero de fabrica | Nostro codice Our code Unser kode Notre code Nuestro codigo | N. denti N. of teeth Zahnezahl N. bre de dents Cantidad de dientes | De | Lu | L |
|---|---|---|--------|-----|-----|
| T5-10 | BT05010 | 10 | 15,05 | 125 | 140 |
| T5-11 | BT05011 | 11 | 16,65 | 125 | 140 |
| T5-12 | BT05012 | 12 | 18,25 | 125 | 140 |
| T5-13 | BT05013 | 13 | 19,85 | 125 | 140 |
| T5-14 | BT05014 | 14 | 21,45 | 132 | 140 |
| T5-15 | BT05015 | 15 | 23,05 | 132 | 140 |
| T5-16 | BT05016 | 16 | 24,60 | 140 | 140 |
| T5-17 | BT05017 | 17 | 26,20 | 140 | 140 |
| T5-18 | BT05018 | 18 | 27,80 | 140 | 140 |
| T5-19 | BT05019 | 19 | 29,40 | 140 | 140 |
| T5-20 | BT05020 | 20 | 31,00 | 160 | 160 |
| T5-21 | BT05021 | 21 | 32,70 | 160 | 160 |
| T5-22 | BT05022 | 22 | 34,15 | 160 | 160 |
| T5-23 | BT05023 | 23 | 35,85 | 160 | 160 |
| T5-24 | BT05024 | 24 | 37,40 | 160 | 160 |
| T5-25 | BT05025 | 25 | 38,95 | 160 | 160 |
| T5-26 | BT05026 | 26 | 40,60 | 160 | 160 |
| T5-27 | BT05027 | 27 | 42,20 | 160 | 160 |
| T5-28 | BT05028 | 28 | 43,75 | 160 | 160 |
| T5-29 | BT05029 | 29 | 45,35 | 160 | 160 |
| T5-30 | BT05030 | 30 | 46,95 | 160 | 160 |
| T5-32 | BT05032 | 32 | 50,10 | 160 | 160 |
| T5-34 | BT05034 | 34 | 53,25 | 160 | 160 |
| T5-35 | BT05035 | 35 | 54,85 | 160 | 160 |
| T5-36 | BT05036 | 36 | 56,45 | 160 | 160 |
| T5-37 | BT05037 | 37 | 58,06 | 160 | 160 |
| T5-38 | BT05038 | 38 | 59,65 | 160 | 160 |
| T5-40 | BT05040 | 40 | 62,85 | 160 | 160 |
| T5-42 | BT05042 | 42 | 66,00 | 160 | 160 |
| T5-44 | BT05044 | 44 | 69,20 | 160 | 160 |
| T5-45 | BT05045 | 45 | 70,80 | 160 | 160 |
| T5-46 | BT05046 | 46 | 72,40 | 160 | 160 |
| T5-48 | BT05048 | 48 | 75,55 | 160 | 160 |
| T5-50 | BT05050 | 50 | 78,75 | 160 | 160 |
| T5-60 | BT05060 | 60 | 94,65 | 160 | 160 |
| T5-72 | BT05072 | 72 | 113,75 | 160 | 160 |
| T5-80 | BT05080 | 80 | 126,48 | 160 | 160 |
| T5-90 | BT05090 | 90 | 142,40 | 160 | 160 |
| T5-100 | BT05100 | 100 | 158,31 | 160 | 160 |

| Codice Code symbol Fabriknummer Code symbole Numero de fabrica | Nostro codice Our code Unser kode Notre code Nuestro codigo | N. denti N. of teeth Zahnezahl N. bre de dents Cantidad de dientes | De | Lu | L |
|---|---|---|--------|-----|-----|
| T10-10 | BT10010 | 10 | 29,98 | 140 | 140 |
| T10-11 | BT10011 | 11 | 33,16 | 140 | 140 |
| T10-12 | BT10012 | 12 | 36,35 | 140 | 140 |
| T10-13 | BT10013 | 13 | 39,50 | 140 | 140 |
| T10-14 | BT10014 | 14 | 42,70 | 160 | 160 |
| T10-15 | BT10015 | 15 | 45,90 | 160 | 160 |
| T10-16 | BT10016 | 16 | 49,10 | 160 | 160 |
| T10-17 | BT10017 | 17 | 52,25 | 160 | 160 |
| T10-18 | BT10018 | 18 | 55,45 | 160 | 160 |
| T10-19 | BT10019 | 19 | 58,65 | 160 | 160 |
| T10-20 | BT10020 | 20 | 61,80 | 160 | 160 |
| T10-21 | BT10021 | 21 | 65,00 | 160 | 160 |
| T10-22 | BT10022 | 22 | 68,20 | 160 | 160 |
| T10-23 | BT10023 | 23 | 71,35 | 160 | 160 |
| T10-24 | BT10024 | 24 | 74,55 | 160 | 160 |
| T10-26 | BT10026 | 26 | 80,90 | 160 | 160 |
| T10-28 | BT10028 | 28 | 87,25 | 160 | 160 |
| T10-30 | BT10030 | 30 | 93,65 | 160 | 160 |
| T10-32 | BT10032 | 32 | 100,00 | 160 | 160 |
| T10-34 | BT10034 | 34 | 106,40 | 160 | 160 |
| T10-36 | BT10036 | 36 | 112,75 | 160 | 160 |
| T10-38 | BT10038 | 38 | 119,10 | 160 | 160 |
| T10-40 | BT10040 | 40 | 125,45 | 160 | 160 |
| T10-45 | BT10045 | 45 | 141,40 | 160 | 160 |
| T10-48 | BT10048 | 48 | 150,95 | 160 | 160 |
| T10-60 | BT10060 | 60 | 189,10 | 160 | 160 |
| T10-72 | BT10072 | 72 | 227,29 | 160 | 160 |

Per barre con n. di denti non inclusi in queste tavole, chiedere per quotazione.

For bars with a number of teeth not included in these tables please ask for our quotation.

Verlangen sie Angebot für Stangen mit anzahl von Zaehnen die nicht in diesen Tafeln aufgefuehrt sind.

Pour les barreaux avec un nombre de dents different du tableau, nous consulter.

Pidan oferta por lo que concierne a una cantidad de dientes no incluida en estas tablas.

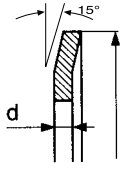
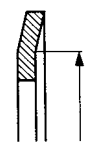
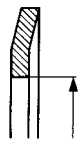

| N. denti N. of teeth Zahnezahl N. bre de dents Cantidad de dientes | Flangia / Flanges / Bordscheiben / Flasques / Tapetas | | | | Tipo flangia Flanges type Bordcheiben Typ Type flasques Tipo tapetas |  |  |  |
|---|---|-------------|-------------|---------------|--|---|---|---|
| | d = 0,5 mm | d = 1 mm | d = 1 mm | d = 1,5 mm | | | | |
| | T 2,5 | T 5 | T 10 | T 20 | | | | |
| 8 | - | - | - | - | F 01 | 13,0 | 10,0 | 6,0 |
| 9 | - | - | - | - | F 02 | 15,0 | 12,0 | 8,0 |
| 10 | - | F 06 | - | - | F 03 | 16,0 | 13,0 | 9,5 |
| 11 | - | - | - | - | F 04 | 17,5 | 14,5 | 11,6 |
| 12 | F 01 | F 07 | F 15 | - | F 05 | 18,0 | 15,0 | 11,5 |
| 13 | - | - | - | - | F 06 | 20,0 | 16,5 | 12,2 |
| 14 | F 02 | F 08 | F 18 | - | F 07 | 23,0 | 18,0 | 12,5 |
| 15 | F 02 | F 09 | F 19 | - | F 08 | 25,0 | 21,5 | 15,0 |
| 16 | F 03 | F 10 | F 20 | - | F 09 | 28,0 | 24,0 | 17,8 |
| 17 | - | - | - | - | F 10 | 32,0 | 27,5 | 23,0 |
| 18 | F 04 | F 10 | F 22 | F 38 | F 11 | 35,0 | 30,5 | 23,0 |
| 19 | F 05 | F 12 | F 25 | - | F 12 | 36,0 | 31,0 | 25,0 |
| 20 | F 06 | F 12 | F 25 | F 43 | F 13 | 37,0 | 33,0 | 25,0 |
| 21 | - | - | - | - | F 14 | 38,0 | 34,0 | 26,5 |
| 22 | F 07 | F 14 | F 27 | F 46 | F 15 | 42,0 | 38,0 | 30,5 |
| 23 | - | - | - | - | F 16 | 43,0 | 39,0 | 31,0 |
| 24 | F 07 | F 15 | F 29 | F 50 | F 17 | 44,0 | 40,5 | 32,5 |
| 25 | F 07 | F 17 | F 29 | F 52 | F 18 | 48,0 | 43,5 | 37,0 |
| 26 | F 08 | F 17 | F 30 | - | F 19 | 51,0 | 47,0 | 40,0 |
| 27 | - | F 18 | F 31 | - | F 20 | 54,0 | 50,5 | 43,0 |
| 28 | F 08 | F 18 | F 32 | - | F 21 | 57,0 | 52,0 | 46,0 |
| 29 | - | - | - | - | F 22 | 60,0 | 57,0 | 47,0 |
| 30 | F 09 | F 19 | F 33 | F 59 | F 23 | 61,0 | 56,5 | 49,0 |
| 31 | - | - | - | - | F 24 | 64,0 | 57,0 | 47,0 |
| 32 | F 10 | F 20 | F 35 | - | F 25 | 66,0 | 63,0 | 52,0 |
| 33 | - | - | - | - | F 26 | 70,0 | 66,5 | 53,0 |
| 34 | - | - | - | - | F 27 | 75,0 | 68,5 | 60,0 |
| 35 | - | - | - | - | F 28 | 79,0 | 72,5 | 60,0 |
| 36 | F 12 | F 24 | F 38 | - | F 29 | 83,0 | 78,0 | 68,0 |
| 37 | - | - | - | - | F 30 | 87,0 | 82,5 | 72,0 |
| 38 | - | - | - | - | F 31 | 91,0 | 85,5 | 76,0 |
| 39 | - | - | - | - | F 32 | 93,0 | 89,0 | 80,0 |
| 40 | F 14 | F 25 | F 41 | - | F 33 | 97,0 | 93,8 | 83,0 |
| 41 | - | - | - | - | F 34 | 102,0 | 97,0 | 82,5 |
| 42 | - | F 26 | - | - | F 35 | 106,0 | 101,0 | 90,0 |
| 43 | - | - | - | - | F 36 | 112,0 | 105,5 | 91,0 |
| 44 | F 15 | - | - | - | F 37 | 115,0 | 109,0 | 94,0 |
| 45 | - | - | - | - | F 38 | 120,0 | 112,5 | 99,5 |
| 46 | - | - | - | - | F 39 | 123,0 | 117,5 | 107,0 |
| 47 | - | - | - | - | F 40 | 128,0 | 124,0 | 107,0 |
| 48 | - | - | - | - | F 41 | 131,0 | 125,5 | 115,0 |
| 49 | - | - | - | - | F 42 | 135,0 | 128,5 | 115,0 |
| 50 | - | - | - | - | F 43 | 138,0 | 132,0 | 121,0 |
| 51 | - | - | - | - | F 44 | 140,0 | 125,0 | 107,0 |
| 52 | - | - | - | - | F 45 | 142,0 | 137,0 | 120,0 |
| 53 | - | - | - | - | F 46 | 146,0 | 133,0 | 107,0 |
| 54 | - | - | - | - | F 47 | 148,0 | 143,0 | 132,0 |
| 55 | - | - | - | - | F 48 | 150,0 | 145,0 | 130,0 |
| 56 | - | - | - | - | F 49 | 154,0 | 142,0 | 122,0 |
| 57 | - | - | - | - | F 50 | 158,0 | 153,0 | 138,5 |
| 58 | - | - | - | - | F 51 | 160,0 | 148,0 | 120,0 |
| 59 | - | - | - | - | F 52 | 168,0 | 161,0 | 148,0 |
| 60 | - | - | - | - | F 53 | 175,0 | 170,0 | 157,0 |
| 61 | - | - | - | - | F 54 | 180,0 | 174,0 | 154,0 |
| 62 | - | - | - | - | F 55 | 184,0 | 168,0 | 135,0 |
| 63 | - | - | - | - | F 56 | 188,0 | 176,0 | 150,0 |
| 64 | - | - | - | - | F 57 | 192,0 | 187,0 | 173,0 |
| 65 | - | - | - | - | F 58 | 198,0 | 180,0 | 150,0 |
| 66 | - | - | - | - | F 59 | 200,0 | 193,0 | 180,0 |
| | | | | | F 60 | 205,0 | 189,0 | 160,0 |
| | | | | | F 61 | 212,0 | 200,0 | 162,0 |
| | | | | | F 62 | 226,0 | 214,0 | 190,0 |
| | | | | | F 63 | 230,0 | 222,0 | 200,0 |
| | | | | | F 64 | 240,0 | 224,0 | 192,0 |
| | | | | | F 65 | 250,0 | 228,0 | 200,0 |
| | | | | | F 66 | 256,0 | 240,0 | 220,0 |
| | | | | | F 67 | 265,0 | 240,0 | 213,0 |
| | | | | | F 68 | 275,0 | 253,0 | 225,0 |
| | | | | | F 69 | 286,0 | 277,0 | 242,0 |
| | | | | | F 70 | 296,0 | 287,0 | 260,0 |
| | | | | | F 71 | 300,0 | 280,0 | 252,0 |
| | | | | | F 72 | 325,0 | 305,0 | 278,0 |
| | | | | | F 73 | 350,0 | 330,0 | 302,0 |
| | | | | | F 74 | 375,0 | 355,0 | 328,0 |
| | | | | | F 75 | 405,0 | 380,0 | 354,0 |
| | | | | | F 76 | 430,0 | 406,0 | 380,0 |
| | | | | | F 77 | 455,0 | 432,0 | 405,0 |
| | | | | | F 78 | 480,0 | 457,0 | 430,0 |
| | | | | | F 79 | 530,0 | 508,0 | 481,0 |
| | | | | | F 80 | 595,0 | 572,0 | 544,0 |